

INSTALLATION INSTRUCTION

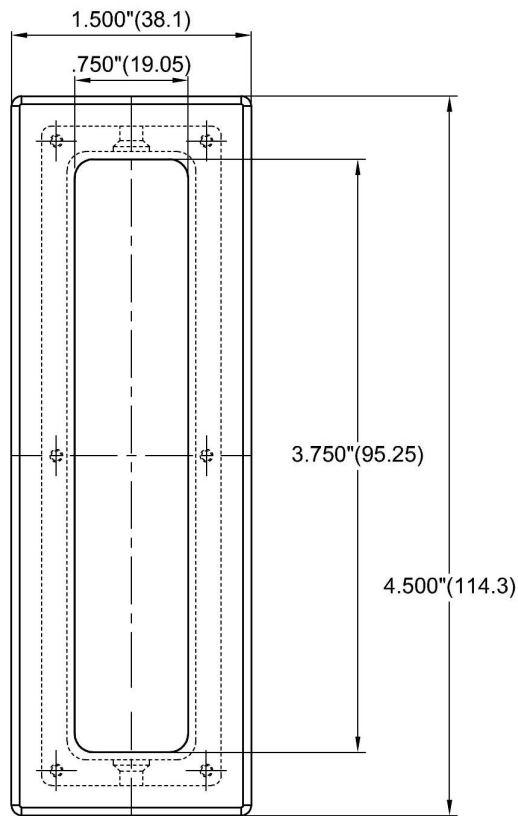

FP14 LIFT

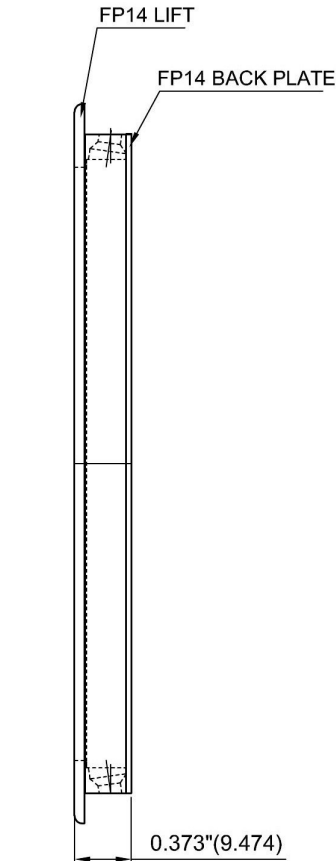
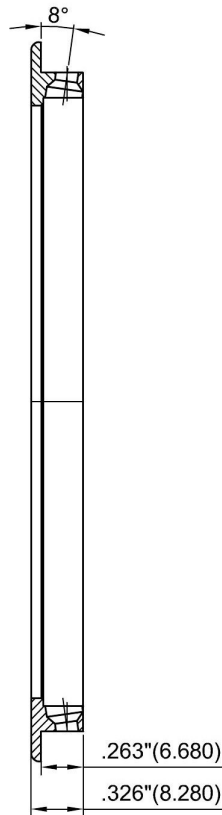

ASSEMBLY

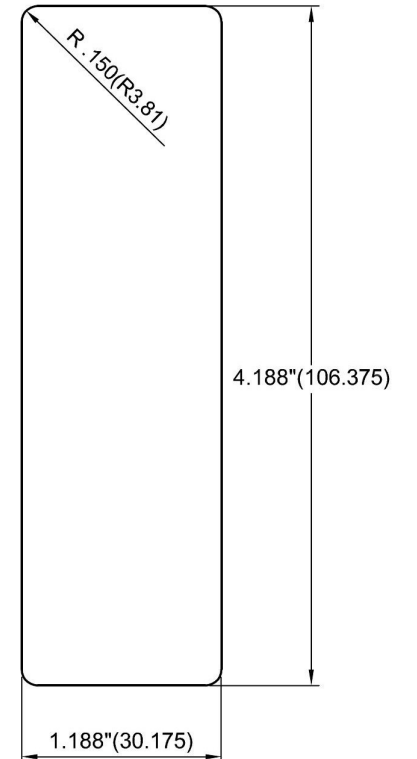

DEPTH IN DOOR HOLE
 DEPTH IN DOOR .325

Screw: 6#-19 X 2
 Metric Millimeters in Parenthesis



FP14 PULL	
DWG#: FP14	Rev. A
MAT'L : BRASS	DATE : 5/10/12