

KINGSLEY

FR42721SLF



Bulbs: 75W MED.

ASSEMBLY INSTRUCTIONS

Assembly of this fixture will be accomplished by first assembling the main fixture body, installing mounting hardware to junction box, mounting the shade to the fixture, installing the glass and related parts and then mounting the fixture to the ceiling.

SAFETY WARNING: Read wiring and grounding instructions [FRIS 18] and any additional directions. Turn power supply off during installation. If new wiring is required, consult a qualified electrician or local authorities for code requirements.

STEP 1

- 1 Prepare mounting strap (a) by threading the two long mounting screws (b) into the back of the mounting strap (a), making sure the holes into which the screws are threaded match the spacing of holes (d) in the canopy (e) - See Drawing 2.
- 2 Attach mounting strap (a) to junction box (j) using two screws (c).
- 3 Make electrical connections from supply wire to fixture lead wires. Refer to instruction sheet [FRIS18] and follow all instructions to make all necessary wiring connections. Then refer back to this sheet to continue installation of this fixture.
- 4 To mount fixture, slip the two mounting screws (b) through the two mounting holes (d) in the backplate (e).
- 5 While holding fixture in place, thread the two ball knobs (f) on to the end of the mounting screws (b), and tighten.

STEP 2

- 1 To install the fixture shade, remove ball knob studs (1) from uprights (2).
- 2 Line up arms (3) of shade (4) with uprights (2).
- 3 Slip ball knob studs (1) through hole in shade arm (3) and thread them into the uprights (2) to secure the shade.

STEP 3

- 1 Thread center stem (5) into coupler (6).
- 2 Slip short tube (7) over center stem (5), followed by check ring (8).
- 3 Slip metal washer (9) over center stem (5), followed by rubber washer (10).
- 4 Slip glass (11) onto center stem (5).
- 5 Slip rubber washer (12) and metal washer (13) over center stem (5).
- 6 Thread hex nut (14) onto center stem (5) and tighten.
- 7 Slip long tube (15) followed by glass bobesche (16) over center stem (5).
- 8 Slip cap (17) onto center stem (5).
- 9 Thread finial (18) onto end of center stem (5) to secure entire assembly.

[DRAWING 1]

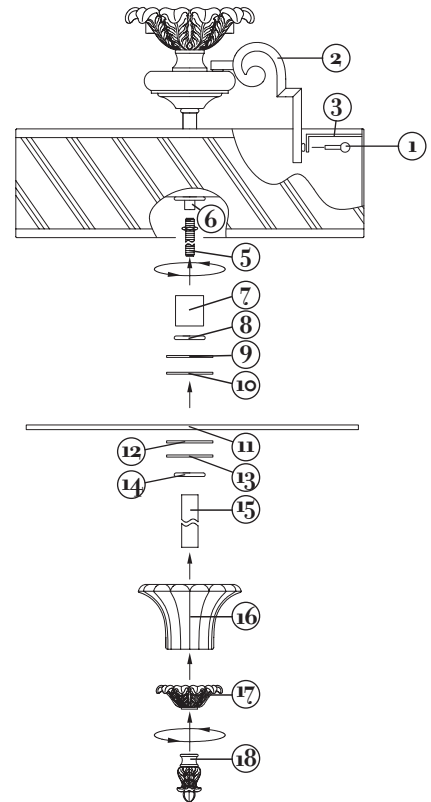

[DRAWING 2]

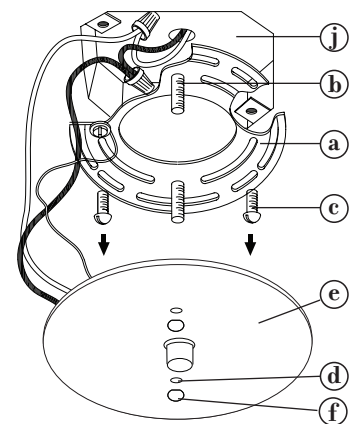

FREDRICK RAMOND
ESTABLISHED 1965

800.421.3517 WWW.FREDRICKRAMOND.COM

6.17.09