

Family: Mayflower | Item No. 5670 OB

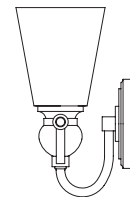

**Drawing 1 - Strap Detail**

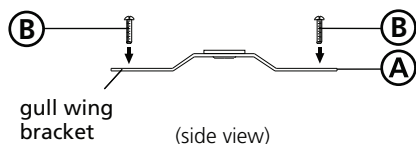

**Drawing 2 - Fixture Mounting**

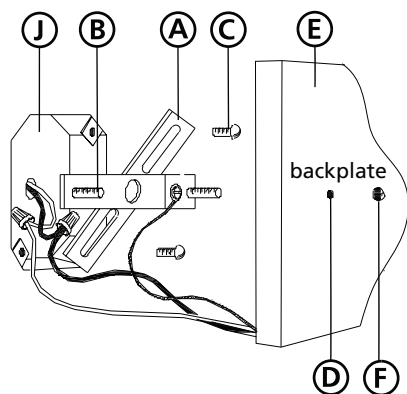

**Drawing 3 - Fixture Assembly**

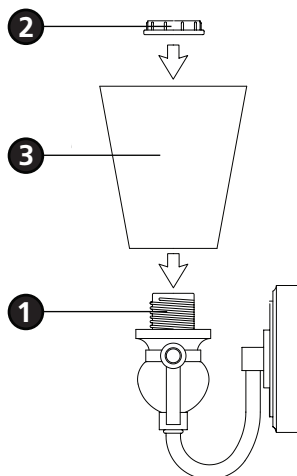

## ▼ start here

**1**

1. Find a clear area in which you can work.
2. Unpack fixture and glass from carton.
3. Carefully review instructions prior to assembly.

**\*\*\* The construction of this fixture will be accomplished by first mounting the mounting strap to the junction box, making all necessary electrical connections, assembling the main body of the fixture, mounting the fixture to the wall, and then installing the glass.**

**2**

1. Prepare gem strap **(A)** for mounting by threading two screws **(B)** provided into back of gull wing bracket of gem strap **(A)** - see **Drawing 1**.
  - Be sure the holes into which the screws are threaded match the spacing of holes **(D)** in the canopy **(E)** - see **Drawings 1 and 2**.
2. Mount gem strap **(A)** to junction box **(J)**, using the two 1" screws **(C)** provided.

**SAFETY WARNING: READ WIRING AND GROUNDING INSTRUCTIONS (I.S. 18) AND ANY ADDITIONAL DIRECTIONS. TURN POWER SUPPLY OFF DURING INSTALLATION. IF NEW WIRING IS REQUIRED, CONSULT A QUALIFIED ELECTRICIAN OR LOCAL AUTHORITIES FOR CODE REQUIREMENTS.**

**3**

Make electrical connections from supply wire to fixture lead wires. Refer to instruction sheet **(I.S. 18)** and follow all instructions to make all necessary wiring connections. Then refer back to this sheet to continue installation of this fixture.

**4**

1. Mount the fixture by slipping the holes **(D)** in the backplate, over the screws **(B)** in the mounting strap - see **Drawing 2**.
2. Thread on ball knobs **(F)** to secure fixture to wall.

**5**

1. To install glass, remove the socket ring **(2)** from the socket **(1)** - see **Drawing 3**.
2. Place glass **(3)** over the socket **(1)**.
3. Thread socket ring **(2)** back on to socket **(1)** and hand tighten.  
Note: Over tightening could cause damage to glass.
4. Fixture can now be lamped accordingly.

Note: Maximum wattage for 5670 fixture is 100 watts per bulb.

2.7.08