

Family: Sussex | Item No. 4799 EZ/BN

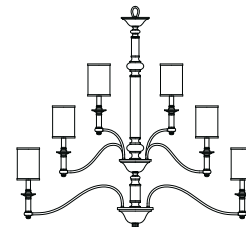

Drawing 1 - Fixture Assembly

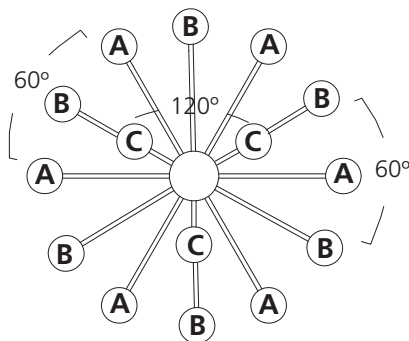

1

1. Find a clear area in which you can work.
2. Unpack fixture and glass from carton.
3. Carefully review instructions prior to assembly.

***** The construction of this fixture will be accomplished by first assembling the main fixture body, installing the mounting hardware, making all necessary electrical connections, hanging the fixture from the ceiling and then installing the fixture shades.**

Drawing 2 - Fixture Assembly

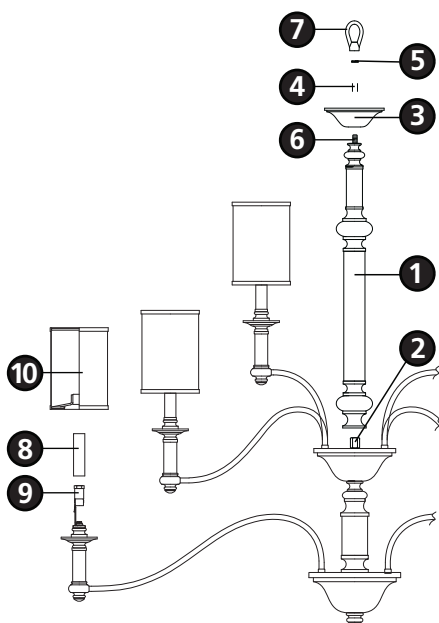

2

SAFETY WARNING: READ WIRING AND GROUNDING INSTRUCTIONS (I.S. 18) AND ANY ADDITIONAL DIRECTIONS. TURN POWER SUPPLY OFF DURING INSTALLATION. IF NEW WIRING IS REQUIRED, CONSULT A QUALIFIED ELECTRICIAN OR LOCAL AUTHORITIES FOR CODE REQUIREMENTS.

1. To assemble fixture, spread arms (A) of main body fixture (1), until they are equally spaced 60 degrees apart - see **Drawing 1**.
2. Spread arms (B) until they are equally spaced 60 degrees apart and equally spaced between the two lower arms (A).
3. Spread arms (C) until they are 120 degrees apart.
4. Slip center column (1) along wire and thread into coupler (2).
5. Slide cap (3), tube (4) and knob nut (5) onto nipple (6).
6. Thread loop (7) onto nipple (6).
7. Slip candle cover (8) onto socket (9).
8. Fixture can now be lamped accordingly.
9. Attach shade (10).
10. Please refer to the hanging instruction sheet (I.S. 19) provided to hang fixture and complete installation.

Note: Maximum wattage for 4799 fixture is 60 watts per bulb.

2.20.09