

Family: Mondrian | Item No. 4570 KZ

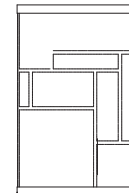

**Drawing 1 - Strap Detail**

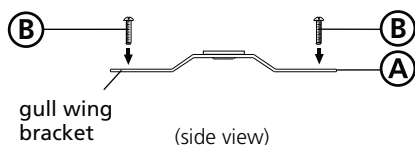

**Drawing 2 - Fixture Mounting**

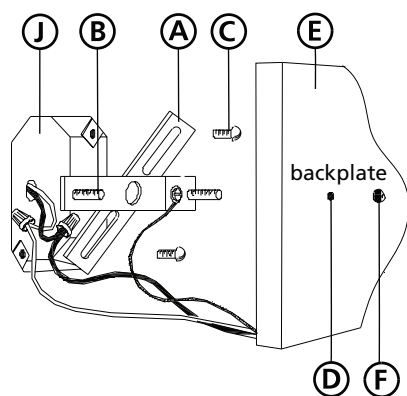

**Drawing 3 - Fixture Assembly**

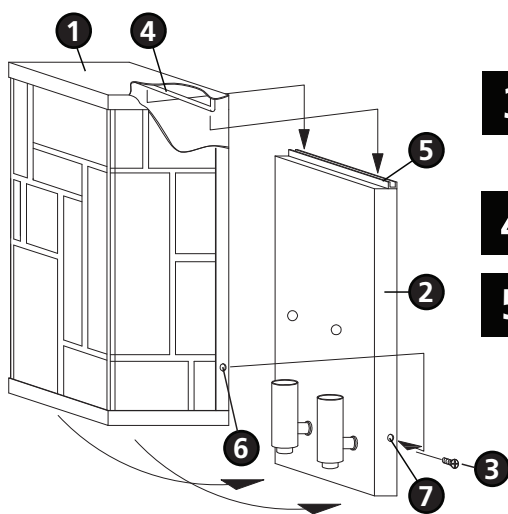

## ▼ start here

**1**

1. Find a clear area in which you can work.
2. Unpack fixture and glass from carton.
3. Carefully review instructions prior to assembly.

**\*\*\* The construction of this fixture will be accomplished by first mounting the mounting strap to the junction box, making all necessary electrical connections, mounting the fixture to the wall and then attaching the glass cage assembly.**

**2**

1. Prepare mounting strap (A) by threading the two 1 1/4" long mounting screws (B) into the back of the gull wing bracket - see **Drawing 1**.
  - Be sure the holes into which the screws are threaded match the spacing of holes (D) in the back plate (E) - see **Drawings 1 and 2**.
2. Attach mounting strap (A) to junction box (J) using two 1" screws (C) provided - see **Drawing 2**.

**SAFETY WARNING: READ WIRING AND GROUNDING INSTRUCTIONS (I.S. 18) AND ANY ADDITIONAL DIRECTIONS. TURN POWER SUPPLY OFF DURING INSTALLATION. IF NEW WIRING IS REQUIRED, CONSULT A QUALIFIED ELECTRICIAN OR LOCAL AUTHORITIES FOR CODE REQUIREMENTS.**

**3**

Make electrical connections from supply wire to fixture lead wires. Refer to instruction sheet (I.S. 18) and follow all instructions to make all necessary wiring connections. Then refer back to this sheet to continue installation of this fixture.

**4**

1. Slide backplate (E) over screws (B) and secure with ball knobs (F) - see **Drawing 2**.

**5**

1. Fixture can now be lamped accordingly.
2. Remove screws (3) from the side of the backplate (2) - see **Drawing 3**.
3. Take cage assembly (2) and hook bar (4) located at the top of the cage assembly (1) into slot (5) located at the top of backplate (2).
4. Pivot cage assembly (1) down onto backplate (2).
5. Line up holes (6) in cage assembly (1) with holes (7) in backplate (2).
6. Thread previously removed screws (3) into holes (6) and (7) and tighten.

Note: Maximum wattage for 4570 fixture is 60 watts per bulb.

10.29.09